

CHUCK RANN

EDISON ENGINEERING 678-471-3463

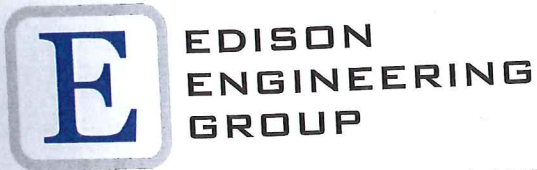
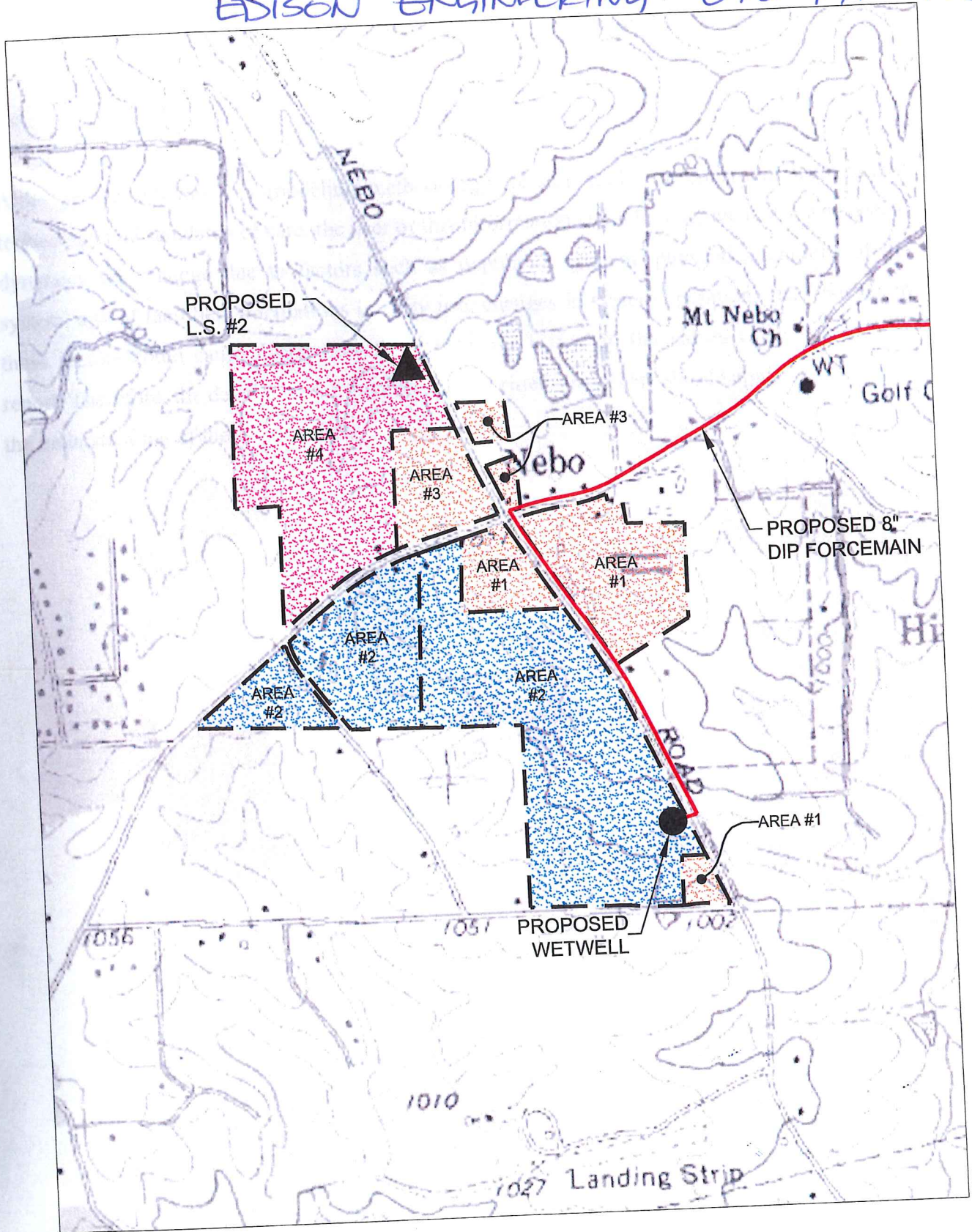

EDISON  
ENGINEERING  
GROUP

**FIGURE NO. 2  
NEBO ROAD SEWER  
LIFT STATION AND FORCE MAIN  
SEWER BASIN MAP AREA**  
Scale 1" = 1000'

PROJECT NAME: NEBO ROAD LIFT STATION  
 PROJECT NO.: 06-026  
 DESIGNER: JTJ  
 PUMP STATION: NEBO ROAD LIFT STATION #1  
 CALC. #: "C"  
 STATION DESIGN: DUPLEX



**EDISON  
 ENGINEERING  
 GROUP**

MUNICIPAL • ENVIRONMENTAL • LAND PLANNING  
 2203 Marietta Highway • Suite 300  
 Dallas, GA 30157  
 Office (770) 505-8115 • Fax (770) 505-8117

**DESIGN FLOWS**

© Edison Engineering Group, 2007

<u>AREA DESCRIPTION</u>	<u>AREA</u>	<u>UNITS</u>	<u>FLOW PER CAPITA</u>	<u>AVERAGE DAILY FLOW (GPD)</u>
<b>AREA #1</b> PROPOSED COMMERCIAL	28.5	-	1500 GPD/AC	42,750
<b>AREA #2</b> ADDITIONAL BASIN AREA	75.6	235	300 GPD/UNIT	70,500
<b>AREA #3 &amp; 4</b> PUMPED FLOW FROM L.S. #2	81.7	-	-	231,750
<b>TOTAL AREA</b>	<b>185.8</b>			
<b>TOTAL AVERAGE DAILY FLOW (GPD)</b>				<b>345,000</b>
<b>TOTAL AVERAGE DAILY FLOW (GPM)</b>				<b>240</b>
<b>EQUIVALENT NO. OF RESIDENTIAL UNITS @ 300 GPD/UNIT</b>				<b>1150</b>
<b>EQUIVALENT POPULATION AT 3.5 PERSONS/UNIT</b>				<b>4025</b>
<b>PEAK FACTOR</b>				<b>3.0</b>
<b>TOTAL PEAK FLOW (GPD)</b>				<b>571,500</b>
<b>TOTAL PEAK FLOW (GPM)</b>				<b>397</b>

PROJECT NAME: NEBO ROAD LIFT STATION  
 PROJECT NO.: 06-026  
 DESIGNER: JTJ  
 PUMP STATION: NEBO ROAD LIFT STATION #2  
 CALC. #: "C"  
 STATION DESIGN: DUPLEX



**EDISON  
 ENGINEERING  
 GROUP**

MUNICIPAL • ENVIRONMENTAL • LAND PLANNING  
 2203 Marietta Highway • Suite 300  
 Dallas, GA 30157  
 Office (770) 505-8115 • Fax (770) 505-8117

**DESIGN FLOWS - PUMPED FLOW FROM L.S. 2**

© Edison Engineering Group, 2007

<u>AREA DESCRIPTION</u>	<u>AREA</u>	<u>UNITS</u>	<u>FLOW PER CAPITA</u>	<u>AVERAGE DAILY FLOW (GPD)</u>
<b>AREA #3</b> PROPOSED COMMERCIAL	12.9	-	1500 GPD/AC	19,350
<b>AREA #4</b> ADDITIONAL BASIN AREA	68.8	193	300 GPD/AC	57,900
<b>TOTAL AREA</b>	<b>81.7</b>			
<b>TOTAL AVERAGE DAILY FLOW (GPD)</b>				<b>77,250</b>
<b>TOTAL AVERAGE DAILY FLOW (GPM)</b>				<b>54</b>
EQUIVALENT NO. OF RESIDENTIAL UNITS @ 300 GPD/UNIT				258
EQUIVALENT POPULATION AT 3.5 PERSONS/UNIT				903
PEAK FACTOR				3.0
<b>TOTAL PEAK FLOW (GPD)</b>				<b>231,750</b>
<b>TOTAL PEAK FLOW (GPM)</b>				<b>161</b>